



2nd Gen

Magic Hollow Wall Anchor

CODE: 510JM



Applicable thickness of plasterboard:
★6-13mm

Application Scenario

- Lamps
- Pictures
- Light shelves
- Coat racks
- Mirrors
- Photo frames
- Curtain rods
- Other medium weight items

- Smoother installation

- Smaller damage to plasterboard



● Enlarged washer

● Unique claw-like spikes

● Overall length: 35mm (including knife-edge)

● Two sets of differentially designed knife-edges

* Outstanding impact resistance!

- Sleeve designed innovatively with Double-ring T-shaped Lock Mechanism -

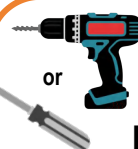
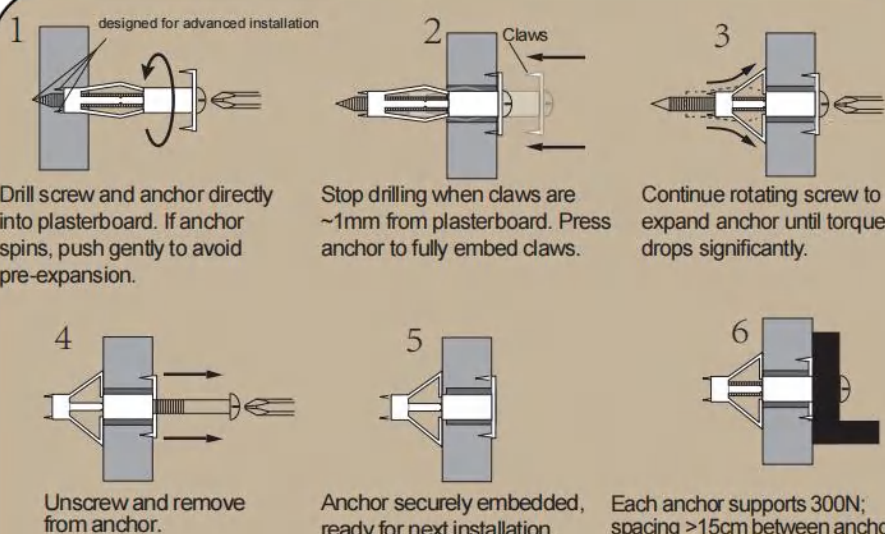

Magic

INSTALLATION

As long as you can turn the screw!

Coming soon...
Coming soon...
Coming soon...
Coming soon...
Coming soon...

For more information, Pls Email:

Chen Xiaojun: jmtmco@outlook.com

Ms. Paney: hongly1@anchor.com.cn

Ms. Grace: sales.d@fastening.com.cn

JMTM Specializes in Design



All products precision-crafted by

Suzhou Litto Fastener Co., Ltd.